

Single Row Tapered Roller Bearing

31300 Series-31324XJ2

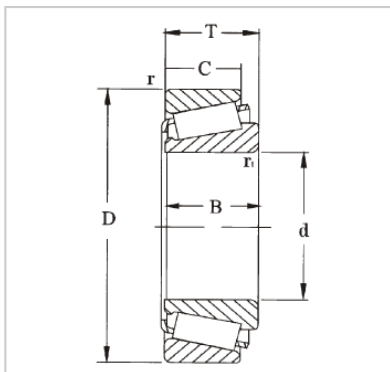

WUXI GUANGQIANG BEARING TRADE CO.,LTD

Обозначение	31324XJ2
Основные размеры (мм)	
d1	120
D	260
B	68
Номинальная грузоподъемность (кН)	
dyc (Cr)	539
stc (Cор)	695
Пу	73.5
Номинальная скорость (об / мин)	
Рейтинги скорости	1700
Ограничение скорости	2400
Вес (кг)	15.5
ISO335	
Размеры (ABMA)	7GB
Размеры (мм)	
d	120
d1 □	190
B	62
C	42
r1,2 (мин)	4
r3,4 (мин)	3
a	78
Размеры абатмента и галтели (мм)	
да (макс)	145
дБ (мин)	135
Да (мин)	203
Да (макс.)	245
Дб (мин)	244
Са (мин)	9
Сb (мин)	26
ра (макс)	3
rb (макс.)	2.5
Ценить	
e	0.83
Y	0.72
Эй	0.4

GQZ high quality 31300 Series Single Row Tapered Roller Bearing

Tapered roller bearings have tapered inner and outer raceways and rollers to handle simultaneous radial and thrust loads. Their axial load carrying capacity is directly related to the contact angle of the rollers and raceway shaft.

They are available in single-row, double-row, and four-row designs. The individual parts of tapered

roller bearings are commonly sold separately as cups and cones. Cones contain the roller assembly and inner ring while cups include the outer ring. Full assembly units contain both the cup and cone. As separable bearings, different designs and sizes are available to accommodate a variety of applications.

Wuxi Guangqiang Bearing Trade Co.,Ltd-Tel:86-510-82601571-Email:gq@gqbearing.com,shary@gqbearing.com-http://www.bearing-asia.com